

# *OMC Associates*

## Arboricultural Survey for Development

---

<b>CLIENT:</b>	<b>Euxton Parish Council</b>
<b>CONTACT:</b>	<b>Stuart Whittle</b>
<b>SITE:</b>	<b>Pear Tree Lane, Euxton, Nr Chorley</b>
<b>CLIENT REF:</b>	<b>N/A</b>
<b>OUR REF:</b>	<b>0517Sv/CJO/2011</b>
<b>INSURED</b>	<b>N/A</b>
<b>INSTRUCTION REC'D:</b>	<b>10 November 2009</b>
<b>DATE OF REPORT:</b>	<b>20 November 2009</b>

---

Prepared by: Christopher Overbeke MSc Arb, BA (Hons), ANC (Dist), M, Arb Ass

**28 Shelford Road, Cambridge, CB2 9NA**  
**Tel: 01223 842253 Fax: 01223 846870 Mob: 07771 708474**  
**Email: [info@omc-associates.co.uk](mailto:info@omc-associates.co.uk)**

# CONTENTS

	<b>Page No.</b>
<b>1.0 Introduction</b>	..... 3
1.1 Brief	..... 3
1.2 Scope of report	..... 3
1.3 Documents	..... 3
1.4 Site description	..... 3
1.5 Proposed development	..... 3
<b>2.0 Trees</b>	..... 4
2.1 Tree data	..... 4
2.2 Trees and the law	..... 4
2.3 Summary of trees	..... 5
2.4 Tree Schedule	..... 6-13
<b>Appendix 1 Key for Tree schedule</b>	
<b>Appendix 2 Existing plan showing crowns and tree positions</b>	
<b>Key plan, Plans A-D</b>	

## **1.0 INTRODUCTION**

### **1.1 Brief**

We are instructed by Stuart Whittle on behalf of Euxton Parish Council, to provide a tree survey to assist with determining the viability creating football pitches on pasture ground on Pear Tree Lane, Euxton.

### **1.2 Scope of report**

To provide a tree survey, that is consistent with the most recently revised version of the British Standard on this subject, "Trees in relation to construction", BS 5837 (2005) and assess whether these represent a constraint to a proposed development.

### **1.3 Documents**

A topographical plan to scale 1:500 has been provided.

### **1.4 Site Description**

The site is a large, level area approximately 300m from east to west and 190m from north to south. It is surrounded by hedges to four sides with a central hedge line dissecting the site into two distinct areas. At present the fields are cropped for silage. There is a depression running along the central axis which is approx 60m long and 15m wide at its widest point and approximately 1.2m deep. All four external boundaries have associated ditches running their lengths and are external to the site boundaries.

Trees of varying age and species are noted along all four boundaries and along the central belt.

### **1.5 Proposed development**

Football pitches are proposed for the site.

## **2.0 Trees**

### **2.1 Trees data**

Dimensions relating to height, crown spread (at four cardinal points where considered necessary), girth at 1.5m as well as age class, structural and physiological condition and BS 5837 (2005) category are noted.

The inspection assesses the height of the crown and suitability to develop near to it.

Though not a detailed assessment of the health of the tree, clear faults are noted.

It must be stressed that absolutely accuracy is essential when plotting trees onto proposed development sites so that scheme can be designed to take account of important trees and there is no need to remove important landscape trees at a later stage because of inaccurate positioning.

Tree numbers have been tagged using aluminium plates onto trees identified on the attached plans.

### **2.2 Trees and the law**

This report does not formally identify whether planning restrictions apply to the trees.

Restrictions can include:

- 1) Tree Preservation Order
- 2) Conservation Area (this has major implications for any tree-work).
- 3) Planning Conditions related to trees and landscape management

Please note that no works around trees should be carried out without the approval of the Local Planning Authority if any such restriction exists (since it is likely to incur large fines) unless planning permission has been granted that indisputably necessitates the removal or facing back of any of these trees. This, however, would not extend to severing of roots of trees shown to be retained on the approved drawings.

Section 197 of the Town & Country Planning Act 1990 states that it shall be the duty of the local planning authority to ensure whenever it is appropriate, that in granting planning permission, "adequate provision is made, by the imposition of conditions, for the preservation or planting of trees"

Paragraph 47 of Planning Policy Guidance 9 Nature Conservation states that the presence of a protected species is a material consideration in considering a planning application which, if implemented would be likely to result in harm to the species or habitat.

The Wildlife & Countryside Act 1981, the Conservation (Natural Habitats etc.) Regulations 1994 and the Countryside.

Even when no specific legal protection exists it may be necessary to obtain a felling license if the volume of timber removed exceeds felling license quotas. The Forestry Commission administers the felling licenses under the Forestry Act 1967.

## 2.4 Summary of trees

Numerous deciduous trees of varying age, quality and species have been noted.

These are located along the four boundaries of the site and along a central East to West belt. The site is characterised and distinguished by a large population of well-established native species trees.

The species comprise predominantly oak in good health though not necessarily all with good individual forms because of close proximity of surrounding trees. Sizeable populations of sycamore and ash are noted with a scattering of hawthorn and silver birch.

There is an overhead power cable which runs along the western boundary and all the trees have been pruned on the East side of this to allow for a way leave. There is also one and one running along the northern boundary.

The hedge line along the eastern boundary between T510 and T538 consists of hawthorn, sycamore, oak alder and elderberry. Between T538 and T550, hazel, and laurel are hawthorn are noted . The height of the hedge line does not exceed 6.0m.

The hedge line along the southern boundary comprises hawthorn between T551 and T565 and then onwards it changes to hazel, *Sorbus* spp., and *Prunus spinosa*.

The hedge along the southern end of the eastern boundary is very sparse, comprising a few hawthorns. It only starts to thicken near T580 where the species develops to predominantly *Prunus spinosa*. Elderberry and holly elements are noted further north. The height of this eastern boundary hedges ranges from 5-6.5m

The hedge along the central east west belt of vegetation is made up of sycamore, hawthorn, hazel, elderberry and rowan.

In general, the hedges feature a good mix of native species that have been left to grow away to heights of up to 6.5m. There would be some merit in pruning back the hedges in parts to improve density and this could be further improved by layering.

Some management would be advisable and can be summarised as follows:

- T534 requires pollarding to ground level
- T535 has a large area of rot at the base and requires pollarding to ground level
- T537 has suffered a lightning strike and is damaged from tip to base and requires pollarding to ground level
- T538 requires minor pruning for power line easement
- T540 has an unbalanced crown and has rot at a major junction, it should be pollarded to ground level.

The following trees should be crown cleaned though this does not represent essential maintenance: T542, T552, T554, T555, T557, T558, T562, T563 and T578

## 2.3 Tree Schedule

TREE No.	SPECIES	HEIGHT (m)	DIA. AT 1.5M (CM)	CROWN RADIUS (m) N S E W	AGE CLASS	LIFE EXPECT -ANCY	CONDITION (STRUCTURAL)	CONDITION (PHYSIOLOGICAL)	FORM	B.S. CAT.	SPACE BELOW CROWN	TREE - WOR
T510	<i>Quercus robur</i> English Oak	14	65	5;4;4;5	2	>40	Good	Good	Good	A	N/A	N
T511	<i>Quercus robur</i> English Oak	10	26	1;3;4;2	2	>40	Average	Average	Fair	C	N/A	N
T512	<i>Fraxinus excelsior</i> Ash	10	16;22	2;3;3;3	2	>40	Average	Average	Fair	C	N/A	N
T513	<i>Fraxinus excelsior</i> Ash	12	26	4;3;4;4	2	>40	Good	Good	Good	B	N/A	N
T514	<i>Fraxinus excelsior</i> Ash	10	22	1;3;3;4	2	>40	Average	Good	Fair	C	N/A	N
T515	<i>Crataegus monogyna</i> Hawthorn	8	14;16	2;2;3;1	2	>40	Average	Good	Fair	C	N/A	N
T516	<i>Fraxinus excelsior</i> Ash	12	16	4;3;0;4	2	>40	Average	Good	Fair	C	N/A	N
T517	<i>Crataegus monogyna</i> Hawthorn	9	16	2;2;0;2	2	>40	Average	Good	Fair	C	N/A	N
T518	<i>Quercus robur</i> English Oak	14	66	5;6;5;7	2	>40	Good	Good	Good	B	N/A	N
T519	<i>Quercus robur</i> English Oak	8	18	0;3;2;0	2	>40	Poor	Average	Poor	C	N/A	N
T520	<i>Acer pseudoplatanus</i> Sycamore	12	29	3;3;2;4	2	>40	Good	Good	Fair	C	N/A	N
T521	<i>Fraxinus excelsior</i> Ash	12	19	2;4;2;4	2	>40	Good	Good	Fair	B	N/A	N
T522	<i>Crataegus monogyna</i> Hawthorn	8	10;12; 6	1;2;0;2	2	>40	Average	Good	Fair	C	N/A	N
T523	<i>Fraxinus excelsior</i> Ash	12	23	3;3;4;3	2	>40	Average	Good	Good	C	N/A	N

T524	<i>Fraxinus excelsior</i> Ash	11	20	3;3;3;3	2	>40	Good	Good	Good	A	N/A	N
T525	<i>Acer pseudoplatanus</i> Sycamore	11	23	2;2;3;4	2	>40	Good	Good	Fair	B	N/A	N
T526	<i>Crataegus monogyna</i> Hawthorn	8	14	2;1;1;2	2	>40	Average	Good	Fair	B	N/A	N
T527	<i>Acer pseudoplatanus</i> Sycamore	9	10	1;2;0;3	2	>40	Average	Good	Fair	C	N/A	N
T528	<i>Fraxinus excelsior</i> Ash	9	11	2;0;0;2	2	>40	Average	Good	Poor	C	N/A	N
T529	<i>Quercus robur</i> English Oak	9	12;14	2;3;0;3	2	>40	Good	Average	Fair	C	N/A	N
T530	<i>Acer pseudoplatanus</i> Sycamore	13	32	3;3;4;4	2	>40	Good	Good	Good	B	N/A	N
T531	<i>Acer pseudoplatanus</i> Sycamore	11	19	3;3;3;2	2	>40	Average	Good	Good	B	N/A	N
T532	<i>Acer pseudoplatanus</i> Sycamore	12	22	3;3;0;4	2	>40	Good	Average	Fair	C	N/A	N
T533	<i>Crataegus monogyna</i> Hawthorn	6	12	2;2;0;2	2	>40	Average	Goof	Fair	B	N/A	N
T534	<i>Acer pseudoplatanus</i> Sycamore	12	35	4;0;2;4	2	>40	Poor	Average	Fair	R	N/A	R
T535	<i>Acer pseudoplatanus</i> Sycamore	12	35	3;4;2;5	2	>40	Low	Poor	Fair	R	N/A	R
T536	<i>Acer pseudoplatanus</i> Sycamore	10	12	1;3;0;3	2	>40	Average	Average	Fair	B	N/A	N
T537	<i>Acer pseudoplatanus</i> Sycamore	11	12;14; 10;11	2;2;0;2	2	>40	Very Poor	Very Poor	Fair	R	N/A	R
T538	<i>Fraxinus excelsior</i> Ash	12	45	4;4;3;4	2	>40	Good	Good	Good	B	N/A	L
T539	<i>Acer pseudoplatanus</i> Sycamore	12	35;28	3;3;3;4	2	>40	Good	Good	Good	C	N/A	N

T540	<i>Fraxinus excelsior</i> Ash	12	65	5;2;2;4	2	>40	Poor	Very Poor	Fair	R	N/A	R
T541	<i>Quercus robur</i> English Oak	12	68	4;4;3;4	2	>40	Good	Good	Good	A	N/A	N
T542	<i>Quercus robur</i> English Oak	12	72	6;1;2;5	2	>40	Poor	Average	Fair	C	N/A	L
T543	<i>Quercus robur</i> English Oak	10	58	3;3;2;5	2	>40	Average	Average	Fair	B	N/A	N
T544	<i>Quercus robur</i> English Oak	11	56	3;4;2;5	2	>40	Good	Good	Fair	A	N/A	N
T545	<i>Quercus robur</i> English Oak	11	55	2;4;2;5	2	>40	Good	Good	Fair	B	N/A	N
T546	<i>Quercus robur</i> English Oak	12	64	6;5;2;5	2	>40	Good	Good	Fair	B	N/A	N
T547	<i>Acer pseudoplatanus</i> Sycamore	12	30;26	3;3;2;3	2	>40	Good	Good	Fair	C	N/A	N
T548	<i>Quercus robur</i> English Oak	8	14	2;1;1;2	2	>40	Average	Good	Fair	C	N/A	N
T549	<i>Quercus robur</i> English Oak	10	48	5;5;2;5	2	>40	Good	Good	Fair	B	N/A	N
T550	<i>Acer pseudoplatanus</i> Sycamore	9	34	2;4;3;3	2	>40	Average	Good	Fair	B	N/A	N
T551	<i>Quercus robur</i> English Oak	9	33	3;5;3;3	2	>40	Average	Average	Fair	B	N/A	N
T552	<i>Quercus robur</i> English Oak	11	89	6;6;6;6	2	>40	Good	Good	Good	A	N/A	L
T553	<i>Quercus robur</i> English Oak	11	68	5;5;6;5	2	>40	Good	Good	Good	A	N/A	N
T554	<i>Quercus robur</i> English Oak	11	63	5;6;6;5	2	>40	Good	Good	Good	A	N/A	L
T555	<i>Quercus robur</i> English Oak	10	58	5;5;5;5	2	>40	Average	Average	Good	B	N/A	L

T556	<i>Acer pseudoplatanus</i> Sycamore	11	57	4;5;5;5	2	>40	Good	Good	Good	A	N/A	N
T557	<i>Quercus robur</i> English Oak	12	84	6;6;6;6;	2	>40	Average	Average	Good	B	N/A	L
T558	<i>Quercus robur</i> English Oak	10	55	6;5;4;5	2	>40	Average	Average	Fair	C	N/A	L
T559	<i>Quercus robur</i> English Oak	12	75	7;6;7;6	2	>40	Good	Good	Fair	A	N/A	N
T560	<i>Quercus robur</i> English Oak	11	64	5;4;5;5;	2	>40	Good	Good	Fair	A	N/A	N
T561	<i>Quercus robur</i> English Oak	11	63	5;5;6;6	2	>40	Good	Good	Good	A	N/A	N
T562	<i>Quercus robur</i> English Oak	11	70	5;5;7;6	2	>40	Good	Good	Good	A	N/A	L
T563	<i>Quercus robur</i> English Oak	11	69	5;5;7;6	2	>40	Good	Good	Good	A	N/A	L
T564	<i>Quercus robur</i> English Oak	10	65	5;5;7;6	2	>40	Good	Good	Fair	A	N/A	N
T565	<i>Quercus robur</i> English Oak	10	64	5;4;4;7	2	>40	Good	Good	Fair	A	N/A	N
T566	<i>Quercus robur</i> English Oak	11	74	6;5;7;7	2	>40	Good	Good	Fair	A	N/A	N
T567	<i>Quercus robur</i> English Oak	10	58	5;5;4;4	2	>40	Good	Good	Good	A	N/A	N
T568	<i>Quercus robur</i> English Oak	10	55	7;8;7;5	2	>40	Good	Good	Fair	A	N/A	N
T569	<i>Quercus robur</i> English Oak	12	65	7;8;7;5	2	>40	Good	Good	Fair	A	N/A	N
T570	<i>Quercus robur</i> English Oak	12	64	5;5;6;5	2	>40	Good	Good	Good	A	N/A	N
T571	<i>Quercus robur</i> English Oak	10	48	5;5;5;4	2	>40	Good	Good	Good	A	N/A	N

T572	<i>Quercus robur</i> English Oak	10	47	4;5;4;5	2	>40	Good	Good	Good	A	N/A	N
T573	<i>Betula pendula</i> Silver birch	9	10	3;2;1;2	2	>40	Good	Good	Fair	B	N/A	N
T574	<i>Betula pendula</i> Silver birch	10	18	1;2;2;2	2	>40	Good	Good	Fair	B	N/A	N
T575	<i>Betula pendula</i> Silver birch	10	18	3;1;2;2	2	>40	Good	Good	Fair	B	N/A	N
T576	<i>Fraxinus excelsior</i> Ash	11	60	6;6;5;5	2	>40	Good	Good	Good	A	N/A	N
T577	<i>Quercus robur</i> English Oak	12	95	0;5;4;4	2	>40	Good	Good	Fair	B	N/A	N
T578	<i>Quercus robur</i> English Oak	12	85	5;9;8;6;	2	>40	Good	Good	Fair	A	N/A	L
T579	<i>Quercus robur</i> English Oak	11	66	4;5;8;8	2	>40	Good	Good	Fair	A	N/A	N
T580	<i>Quercus robur</i> English Oak	11	62	5;3;3;5	2	>40	Good	Good	Fair	B	N/A	N
T581	<i>Fraxinus excelsior</i> Ash	13	65	5;7;6;6	2	>40	Good	Good	Fair	A	N/A	N
T582	<i>Quercus robur</i> English Oak	11	62	6;2;5;7	2	>40	Good	Good	Fair	A	N/A	N
T583	<i>Quercus robur</i> English Oak	11	72	7;8;8;7	2	>40	Good	Good	Good	B	N/A	N
T584	<i>Crataegus monogyna</i> Hawthorn	8	16	3;3;3;2	2	>40	Good	Good	Fair	A	N/A	N
T585	<i>Quercus robur</i> English Oak	9	24	3;3;3;3	2	>40	Good	Good	Good	A	N/A	N
T586	<i>Quercus robur</i> English Oak	8	22	3;3;3;3	2	>40	Good	Good	Good	A	N/A	N
T587	<i>Crataegus monogyna</i> Hawthorn	7	20;18; 12;16	3;3;4;2	2	>40	Good	Good	Fair	A	N/A	N

T588	<i>Quercus robur</i> English Oak	10	44	3;3;6;4	2	>40	Good	Good	Fair	A	N/A	N
T589	<i>Quercus robur</i> English Oak	9	46	3;3;4;5	2	>40	Good	Good	Good	A	N/A	N
T590	<i>Quercus robur</i> English Oak	9	42	4;3;5;4	2	>40	Good	Good	Fair	A	N/A	N
T591	<i>Quercus robur</i> English Oak	9	44	3;3;6;6	2	>40	Average	Average	Fair	B	N/A	N
T592	<i>Quercus robur</i> English Oak	11	48	3;4;4;3	2	>40	Good	Good	Good	A	N/A	N
T593	<i>Quercus robur</i> English Oak	9	50	4;3;4;4	2	>40	Good	Good	Good	A	N/A	N
T594	<i>Quercus robur</i> English Oak	7	46	3;3;2;5	2	>40	Poor	Average	Fair	B	N/A	N
T595	<i>Quercus robur</i> English Oak	11	52	4;4;4;7	2	>40	Good	Good	Fair	A	N/A	N
T596	<i>Quercus robur</i> English Oak	9	44	3;3;4;3	2	>40	Average	Average	Good	A	N/A	N
T597	<i>Quercus robur</i> English Oak	12	70	4;4;5;5	2	>40	Good	Good	Good	A	N/A	N
T598	<i>Quercus robur</i> English Oak	11	60	4;4;4;4	2	>40	Average	Good	Good	A	N/A	N
T599	<i>Quercus robur</i> English Oak	9	57	3;3;3;4	2	>40	Average	Good	Good	A	N/A	N
T600	<i>Quercus robur</i> English Oak	13	61	4;4;5;5	2	>40	Good	Good	Good	A	N/A	N
T601	<i>Quercus robur</i> English Oak	8	41	3;4;3;5	2	>40	Average	Average	Good	A	N/A	N
T602	<i>Quercus robur</i> English Oak	10	40	4;3;3;4	2	>40	Average	Average	Good	A	N/A	N
T603	<i>Quercus robur</i> English Oak	9	62	2;3;2;4	2	>40	Poor	Poor	Fair	C	N/A	N

T604	<i>Fraxinus excelsior</i> Ash	12	35	2;3;3;5	2	>40	Poor	Poor	Good	C	N/A	N
T605	<i>Quercus robur</i> English Oak	10	71	3;4;4;4	2	>40	Good	Good	Good	A	N/A	N
T606	<i>Quercus robur</i> English Oak	14	85	8;5;4;14	2	>40	Good	Good	Fair	A	N/A	N
T607	<i>Quercus robur</i> English Oak	15	84	8;6;8;9	2	>40	Good	Good	Good	A	N/A	N
T608	<i>Quercus robur</i> English Oak	9	28	4;3;3;4	2	>40	Good	Good	Good	A	N/A	N
T609	<i>Quercus robur</i> English Oak	9	26	3;3;3;4	2	>40	Good	Good	Good	A	N/A	N
T610	<i>Quercus robur</i> English Oak	9	28;26	4;4;4;5	2	>40	Good	Good	Fair	A	N/A	N
T611	<i>Quercus robur</i> English Oak	9	18;24	4;4;4;5	2	>40	Good	Good	Good	A	N/A	N
T612	<i>Quercus robur</i> English Oak	10	12;14; 12;14	3;4;4;4	2	>40	Good	Good	Good	A	N/A	N
T613	<i>Quercus robur</i> English Oak	10	35;30	4;8;5;3	2	>40	Good	Good	Fair	B	N/A	N
T614	<i>Quercus robur</i> English Oak	10	32	2;4;2;2	2	>40	Average	Average	Fair	C	N/A	N
T615	<i>Quercus robur</i> English Oak	10	38	3;3;2;2	2	>40	Good	Good	Fair	B	N/A	N
T616	<i>Quercus robur</i> English Oak	10	35;16; 20	2;2;4;6	2	>40	Good	Good	Fair	B	N/A	N
T617	<i>Quercus robur</i> English Oak	10	75	6;6;8;8	2	>40	Good	Good	Good	A	N/A	N
T618	<i>Quercus robur</i> English Oak	10	32	3;4;4;3	2	>40	Good	Good	Good	A	N/A	N
T619	<i>Quercus robur</i> English Oak	10	12;12; 16;16	4;3;4;4	2	>40	Good	Good	Fair	B	N/A	N

T620	<i>Quercus robur</i> English Oak	8	16;14; 12	3;3;6;6;	2	>40	Good	Good	Fair	B	N/A	N
T621	<i>Quercus robur</i> English Oak	9	16;16; 18	3;3;4;4	2	>40	Good	Good	Fair	A	N/A	N
T622	<i>Quercus robur</i> English Oak	9	24	3;3;4;4	2	>40	Good	Good	Good	A	N/A	N
T623	<i>Quercus robur</i> English Oak	9	18;12	3;3;3;0	2	>40	Good	Good	Fair	B	N/A	N

See Appendix 1 for key



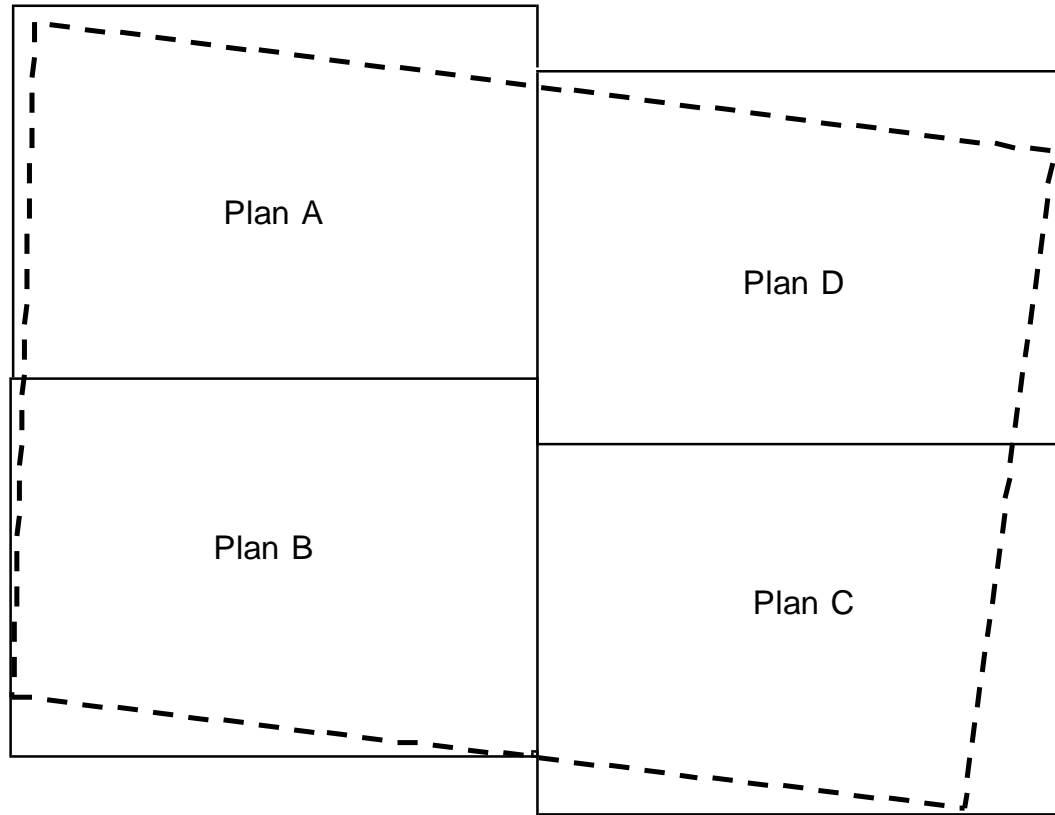

## APPENDIX 1 – KEY FOR TREE DETAILS

<b>Prefix:</b>	<b>T</b> – Tree <b>S</b> – Shrub/Climber <b>TG/SG</b> – Group/Hedge of Trees or Shrubs
<b>Dia.:</b>	<b>N/A</b> = Tree less than 10cm (for shrubs: young, semi-mature or mature) * = Estimate
<b>Age Class:</b>	<p><b>Young</b> - Generally less than 10 years old and high life expectancy</p> <p><b>Semi-Mature</b> - Within first 30% of life expectancy and significant growth to be expected</p> <p><b>Early-Mature</b> - Typically 30-60% of life expectancy, full size almost reached</p> <p><b>Mature</b> - Typically 60% or more of life expectancy, full size reached with very gradual, slight further increases in size</p> <p><b>Over-Mature</b> - A stage of development where intervention/management may be required to ensure the tree remains safe</p> <p><b>Veteran</b> - Where a tree is so senescent that management is not worthwhile</p>
<b>Life Expectancy:</b>	How many years before tree likely to need removing <10, 10-20, 20-40, >40
<b>Crown Radius:</b>	Where crown is symmetrical only one dimension is given for the diameter
<b>B.S. Category:</b>	<p>A – Those of high quality and value i.e. make a substantial contribution</p> <p>B - Those of good/moderate quality and value i.e. might be included in cat. “A” but slightly impaired</p> <p>C - Those of moderate/low quality and value i.e. adequate to remain until new planting is established or young tree with a stem diameter &lt; 150mm</p> <p>R - Those of such poor condition that any existing value would be lost within 10 years</p> <p><b>1 - Landscape value                      2 – Arboricultural value                      3 – Ecological value</b></p>
<b>Physiological Condition:</b>	<p><b>Good</b> - Healthy tree with no symptoms of significant disease</p> <p><b>Fair</b> - Some disease noted and/or vitality is below what would be expected</p> <p><b>Poor</b> - Significant disease noted and/or very low vitality</p> <p><b>Very Poor</b> - Tree is dying</p>
<b>Structural Condition:</b>	<p><b>Good</b> - No significant structural defects</p> <p><b>Fair</b> - Defects noted but not sufficient to warrant immediate work</p> <p><b>Poor</b> - significant defects. Monitoring and/or remedial works required</p> <p><b>Very Poor</b> - Significant defects requiring immediate work or tree removal</p>
<b>Form:</b>	<p>This is included to assist in determining the amenity value of a tree based on appearance alone. There may be no obvious structural or physiological defects but because of poor form for the species it has little merit.</p> <p><b>Very Good</b> - Excellent shape for the species</p> <p><b>Good</b> - Slightly impaired shape but likely to grow into “Very Good” category</p> <p><b>Fair</b> - Impaired/asymmetric but nonetheless is recognizable as typical of the species and may right itself or be significantly enhanced through remedial treework</p> <p><b>Poor</b> - Poor, asymmetric tree (that may have no other apparent faults) with little aesthetic merit as an individual tree (but may have merit as part of a group)</p>
<b>Space Below Crown:</b>	<p>A useful indicator to determine the practicality of working below the crown. Rather than a measurement, a simple Y (Yes) or N (No) or N/A is provided. The yardstick is 2.6m+ not less than 1.5m+ from stem.</p> <p><b>Y</b> - Potential to develop below the dripline with either no treework or removal of limbs that will not adversely affect the health and appearance of the tree.</p> <p><b>N</b> - No scope to develop below the dripline of the tree</p> <p><b>N/A</b> - Tree to be removed (or beyond development operations)</p>
<b>Treework:</b>	<p>This is necessarily kept general at this stage since the report is not a tree-work specification. It indicates:</p> <p><b>H</b> - High priority. For trees to be retained and where work required to make safe*</p> <p><b>L</b> - No urgent work required but would benefit from a crown clean or some other intervention</p> <p><b>N</b> - No treework identified as necessary in the foreseeable future</p> <p><b>R</b> - Remove – tree identified to be removed because “R” category tree</p>

# APPENDIX 1 - KEY PLAN



BS5837 (2005) Classification

-  A
-  B
-  C
-  R
-  Where crown line is broken, indicates removal

<b>OMC Associates T: 01223 842253</b>				
CLIENT: Euxton Parish Council	SITE: Pear Tree La, Euxton, Chorley	SCALE: 1:500	TITLE: BS Tree Survey	Ref: 0517SV

# PLAN A

OMC Associates T: 01223 842253

CLIENT: Euxton Parish Council SITE: Pear Tree La, Euxton, Chorley  
SCALE: 1:500 TITLE: BS Tree Survey Ref: 0517SVa

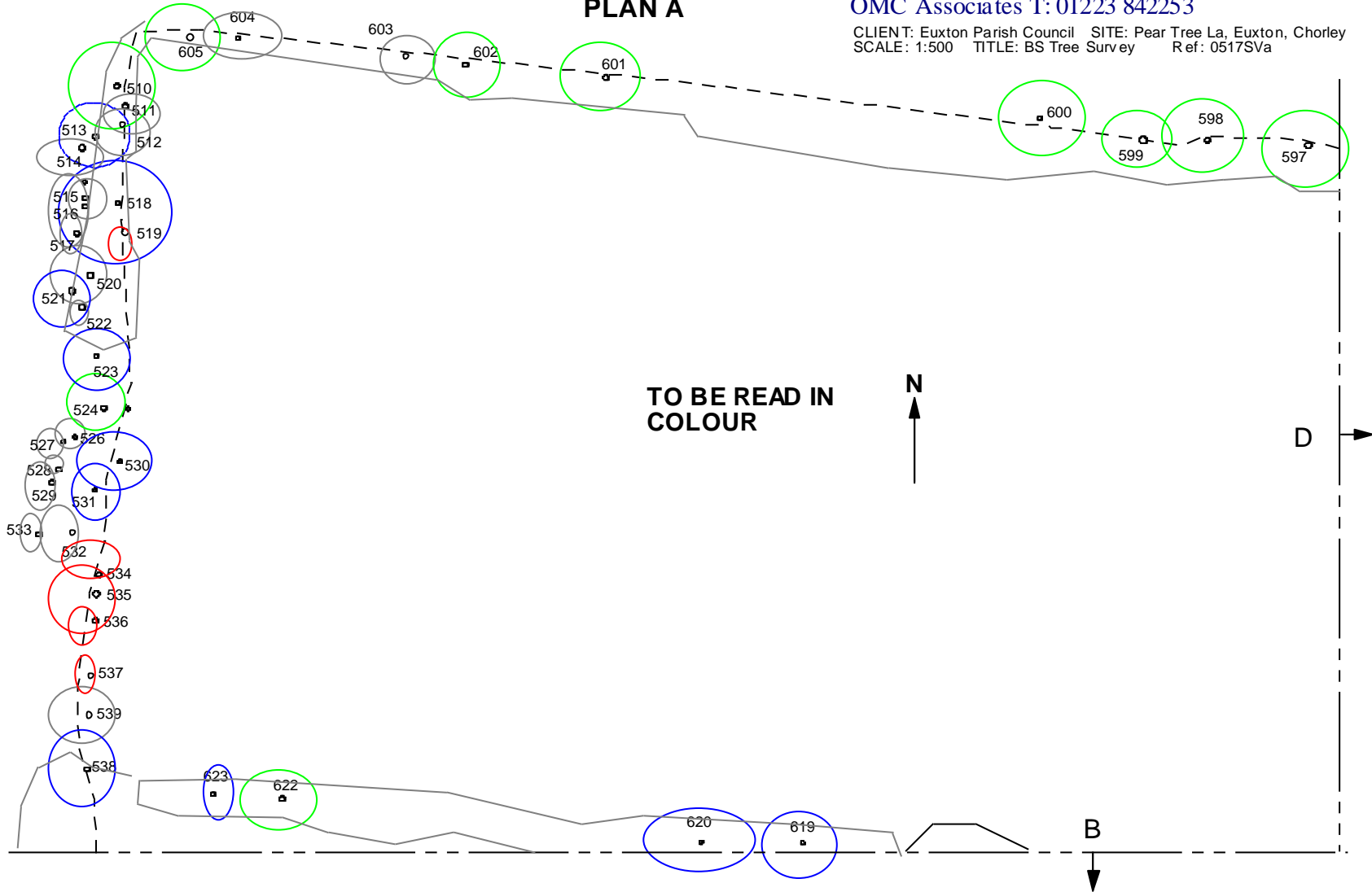

# PLAN B

OMC Associates T: 01223 842253

CLIENT: Euxton Parish Council SITE: Pear Tree La, Euxton, Chorley  
SCALE: 1:500 TITLE: BS Tree Survey Ref: 0517SVb

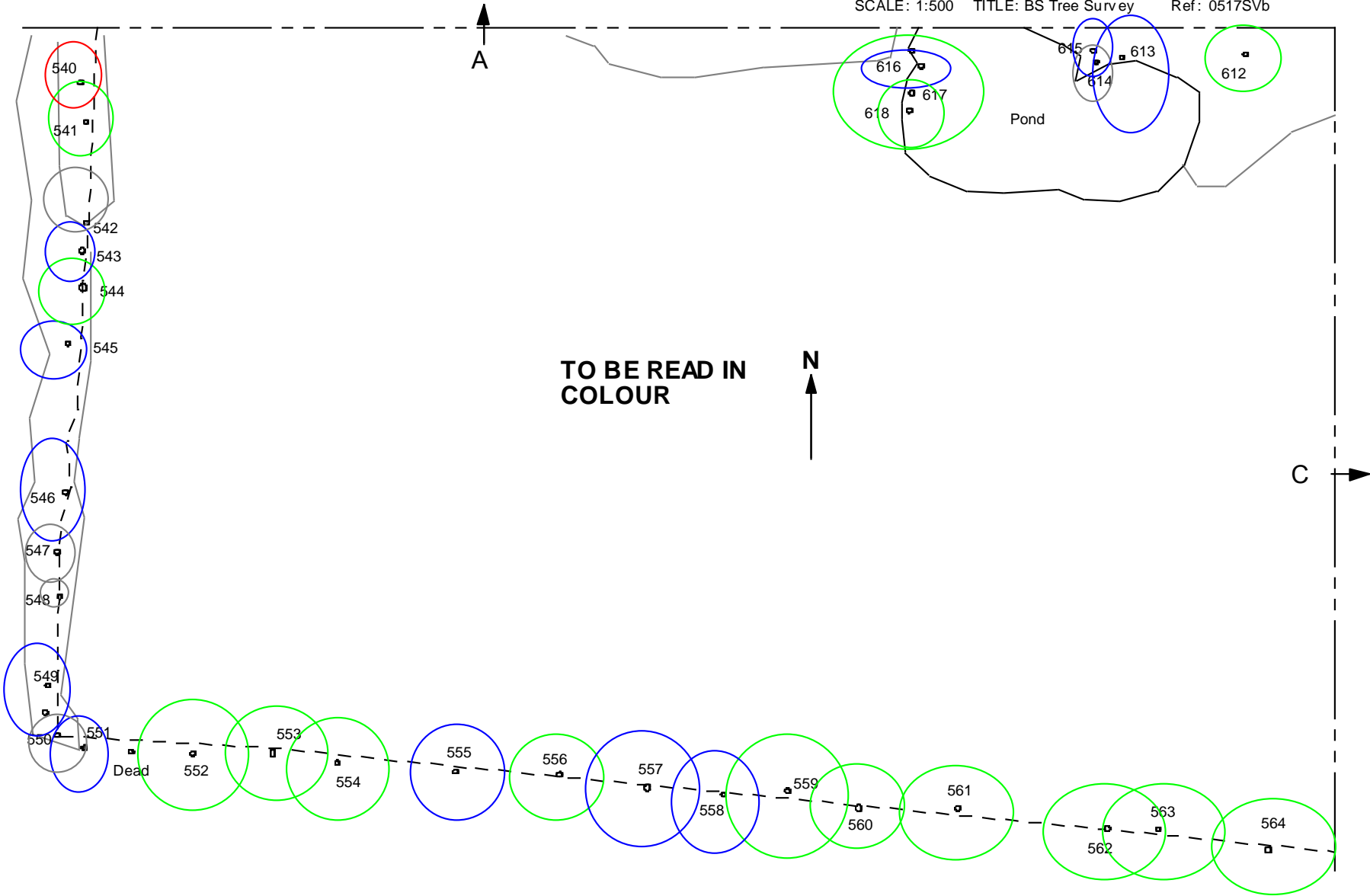

# PLAN C

OMC Associates T: 01223 842253

CLIENT: Euxton Parish Council SITE: Pear Tree La, Euxton, Chorley  
SCALE: 1:500 TITLE: BS Tree Survey Ref: 0517SVc

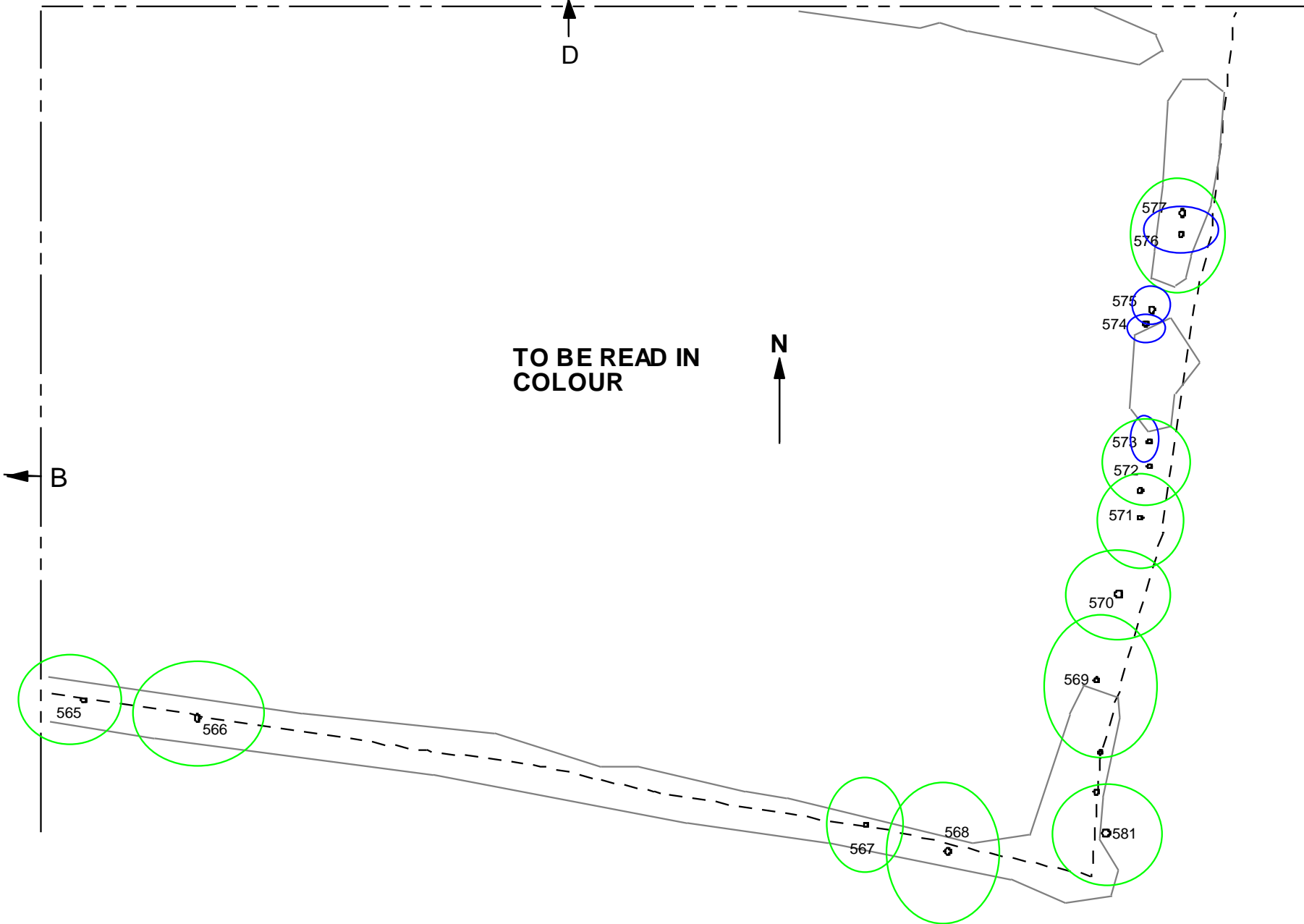

# PLAN D

OMC Associates T: 01223 842253

CLIENT: Euxton Parish Council SITE: Pear Tree La, Euxton, Chorley  
SCALE: 1:500 TITLE: BS Tree Survey Ref: 0517SVd

